

SAVE THESE INSTRUCTIONS, **CAUTION**, RISK OF FIRE:

- This product must be installed by a qualified electrician. - Turn off power at circuit breaker before installing.
- To reduce risk of fire or electrical shock use this fixture indoors only.

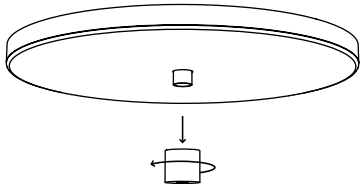

1 Unthighten pieces following figures 1 to 2



2

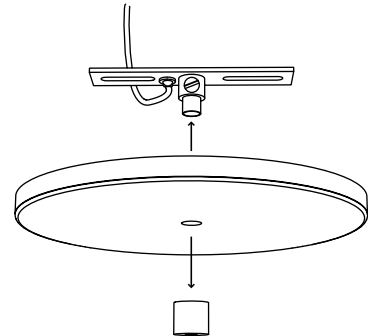

3 Feed the cord through all pieces into the canopy, as shown in below figure.

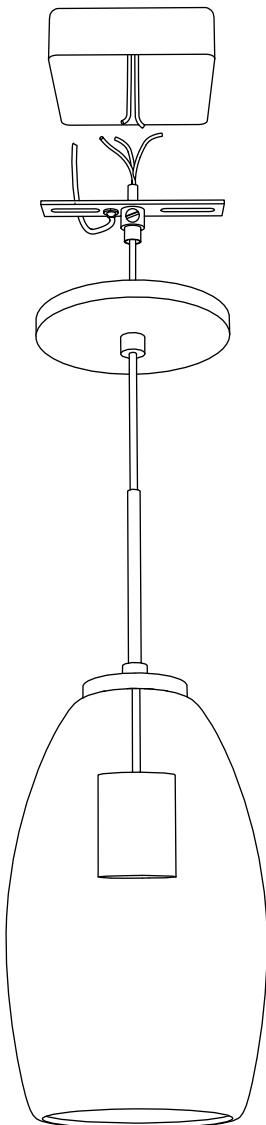

ADJUST THE FIXTURE HEIGHT

4 Adjust the height by moving the cord up or down. use a screwdriver to tighten the setscrew when desired height is achieved.

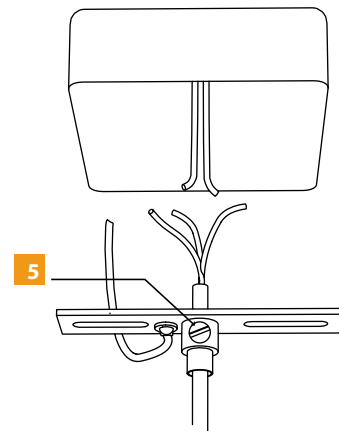

5 Connect the black and white wires from the fixture to the corresponding power and neutral wires in electrical box using supplied wire nuts.

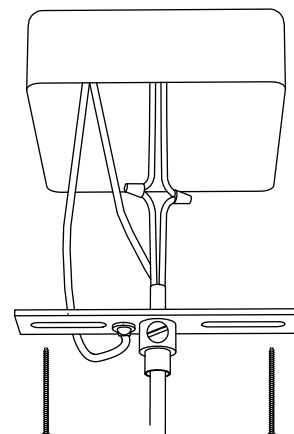

INSTALL LAMP

- 6** Slide the glass up to install the lamp

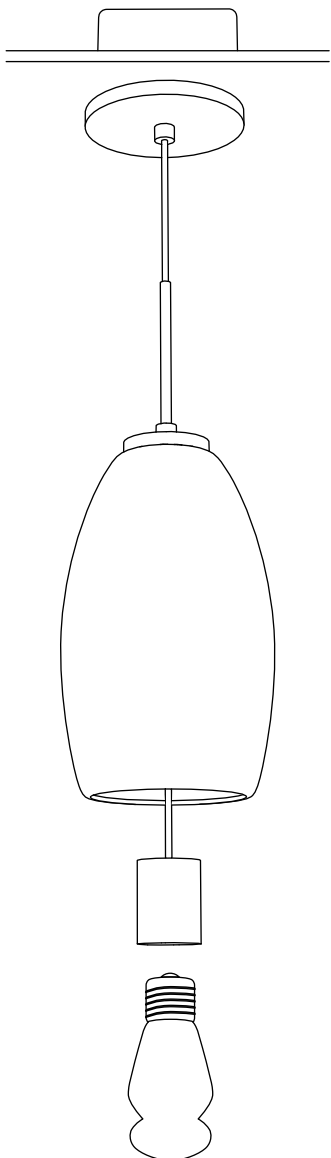

- 7** Hold the socket while installing bulb

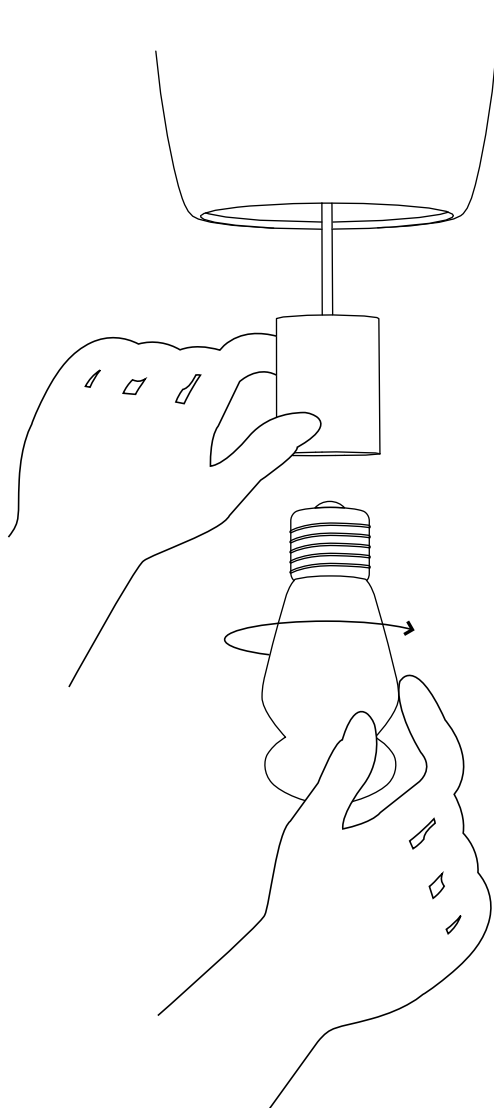

- 8** After installing the lamp slide the glass down

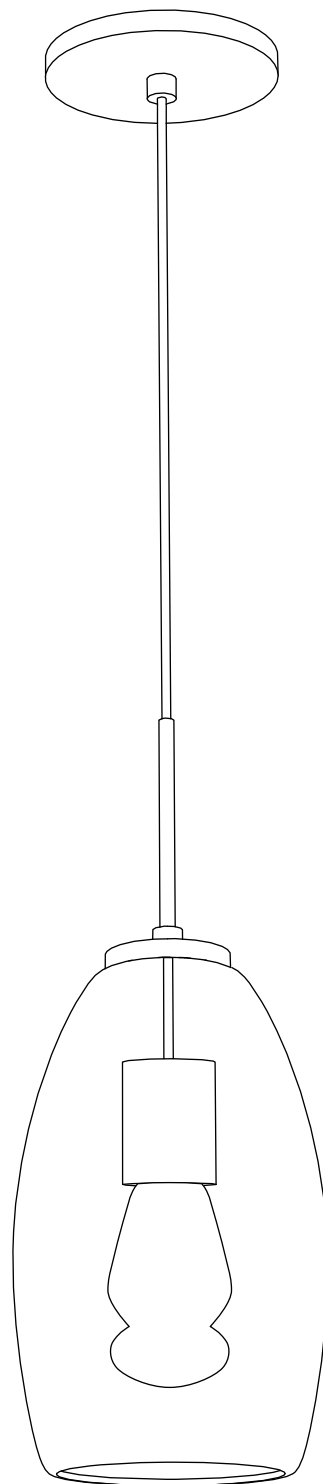

SAVE THESE INSTRUCTIONS